



MODEL: WP1000RC

MOUNTING INSTRUCTIONS FOR FLUSH MOUNT WHILE-IN-USE COVER

First, determine the method to mount the Junction Box (plywood or stud).

Plywood Mount (figure 1)

1. Use Junction Box opening as template to cut hole in plywood.
2. Cut off two stud mounting brackets.
3. Slide Junction Box through plywood opening and mount using nails or screws (not included).

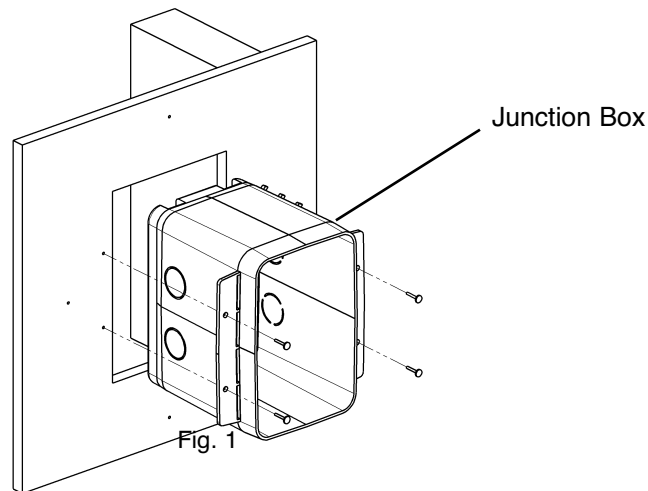

Stud Mount (figure 2)

1. Position Junction Box along stud with opening extending between 1/2" and 1" past front of stud and mount with nails or screws (not provided). Note: the depths may vary depending upon expected finish material - plywood, wrap, foam board, siding, etc.
2. Cut off two plywood mounting brackets if necessary (or use as a guide)

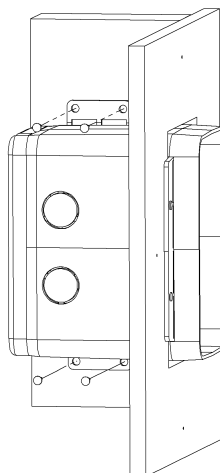

Fig. 2

Mounting Siding Flange (figures 3 and 4)

1. Position Siding Flange over Junction Box opening and mount to plywood using nails or screws (not provided).
2. Siding and other materials may be installed using flange as a channel to provide a clean finish.

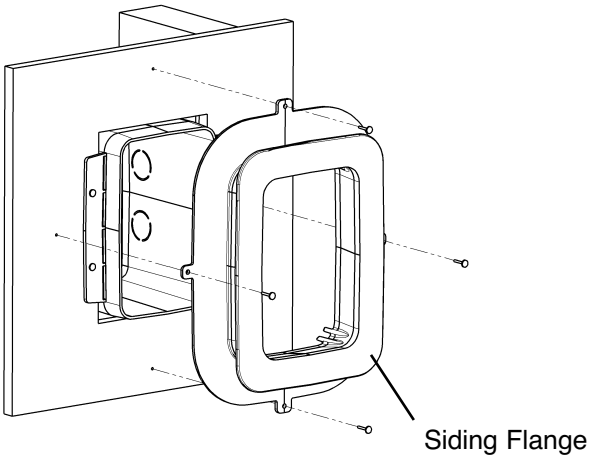

Fig. 3

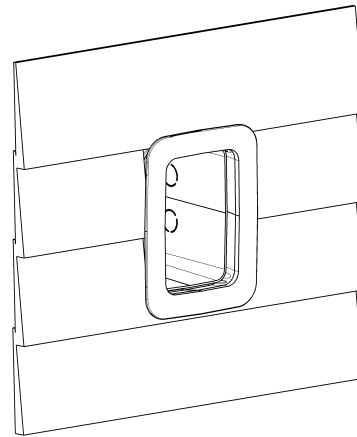

Fig. 4

Brick Mounting (figure 5)

1. Cut off Stud Brackets and Plywood Brackets.
2. Leave Junction Box to be positioned in brickwork with opening set back 1/8" or more inside brick.

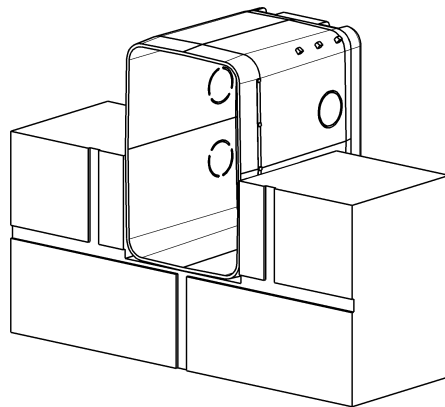

Fig. 5

Stucco Mounting (figure 6)

1. Cut off Stud Brackets.
2. Cut hole in plywood or block (if block construction).
3. Secure Junction box using plywood brackets and screws or nails (not provided).

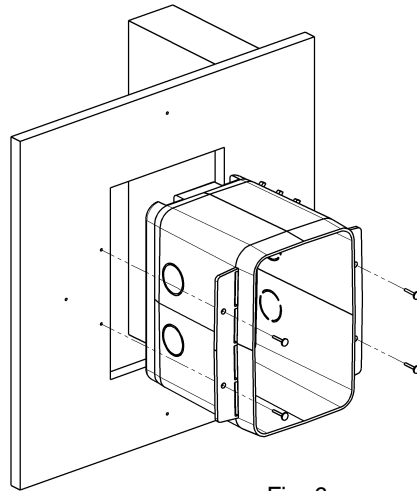

Fig. 6

Finish Mounting (figure 7)

1. Select insert for appropriate device to be installed.
2. Remove any mounting screws provided with the device.
3. Mount device to insert using screws provided.
4. Snap Insert with device into Recessed Sleeve.
5. Wire device according to device manufacturers instructions.
6. Slide Recessed Sleeve into Junction Box as far back as necessary for gasket.
7. Secure Sleeve to Junction Box using screws provided.
8. Snap hinged Cover into place.

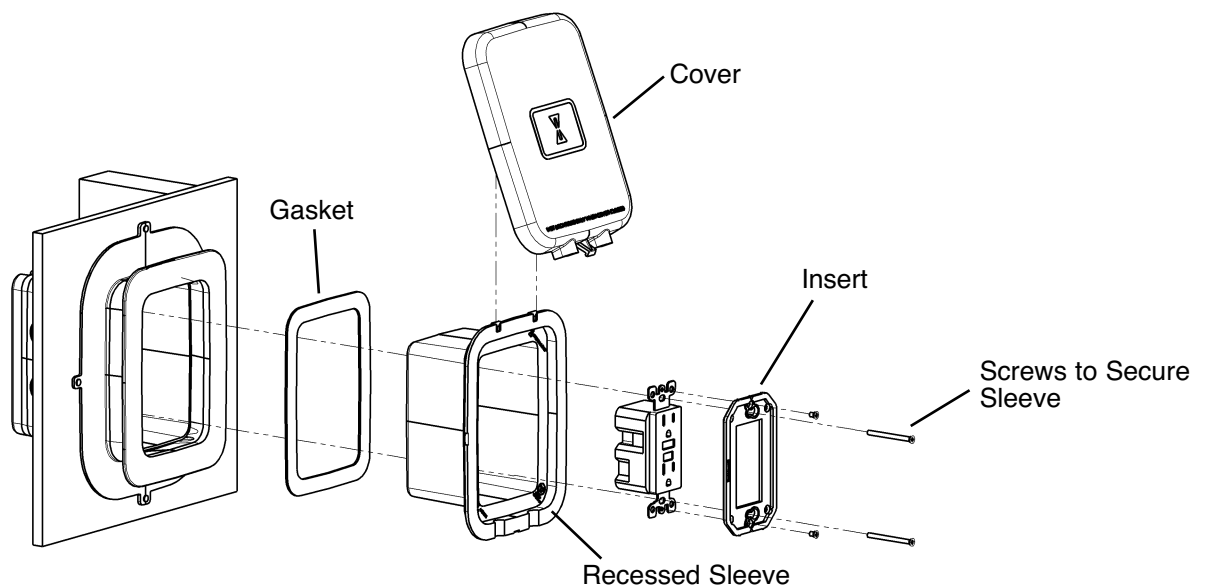
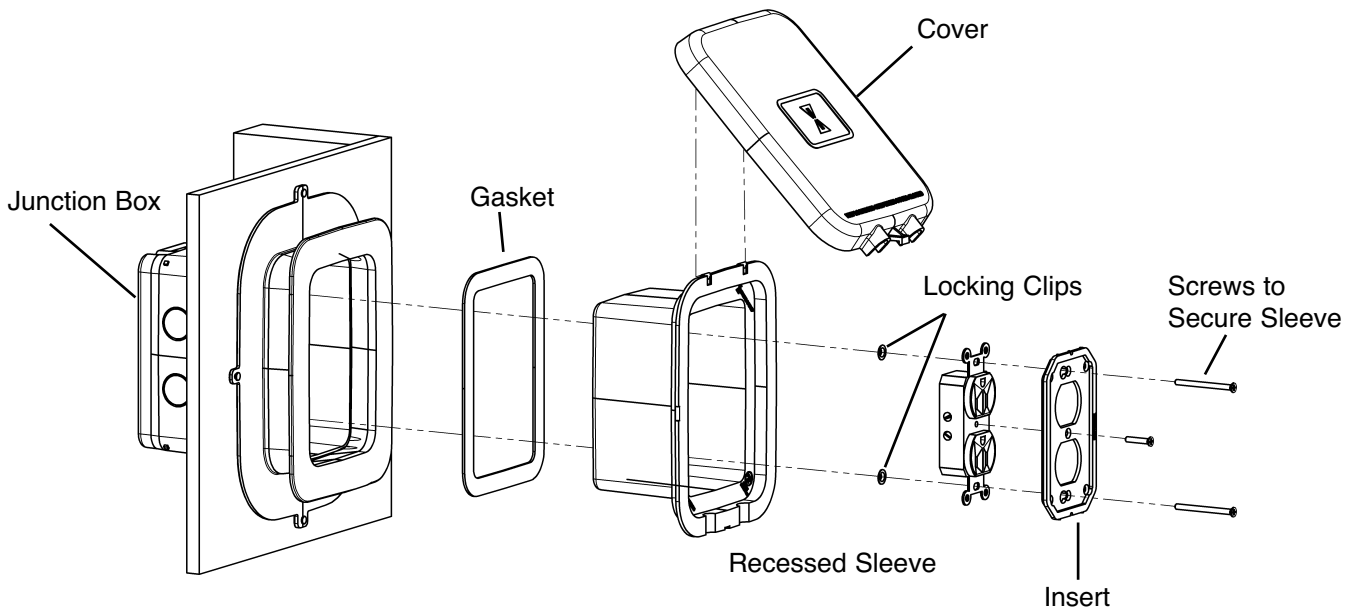

Fig. 7

Finish Mounting - Duplex Receptacle (figure 8)

1. Select duplex receptacle insert.
2. Remove any mounting screws provided with device.
3. Mount device using screw provided.
4. Place and hold screws (to secure sleeve) through plate and secure with Locking Clips. Locking Clips should be seated firmly against receptacle yoke, allowing the screw to turn only.
5. Snap Insert with device into Recessed Sleeve.
6. Wire device according to device manufacturers instructions.
7. Slide Recessed Sleeve into Junction Box as far as screws (to secure sleeve) allow.
8. Secure Sleeve to Junction Box using these screws. Alternate between the two screws after tightening 3-4 revolutions.
9. Snap hinged Cover into place.



LIMITED 1 YEAR WARRANTY

If within one (1) year from the date of purchase, this product fails due to a defect in material or workmanship, Intermatic Incorporated will repair or replace it, at its sole option, free of charge. This warranty is extended to the original household purchaser only and is not transferable. This warranty does not apply to: (a) damage to units caused by accident, dropping or abuse in handling, acts of God or any negligent use; (b) units which have been subject to unauthorized repair, opened, taken apart or otherwise modified; (c) units not used in accordance with instructions; (d) damages exceeding the cost of the product; (e) sealed lamps and/or lamp bulbs, LED's and batteries; (f) the finish on any portion of the product, such as surface and/or weathering, as this is considered normal wear and tear; (g) transit damage, initial installation costs, removal costs, or reinstallation costs.

INTERMATIC INCORPORATED WILL NOT BE LIABLE FOR INCIDENTAL OR CONSEQUENTIAL DAMAGES. SOME STATES DO NOT ALLOW THE EXCLUSION OR LIMITATION OF INCIDENTAL OR CONSEQUENTIAL DAMAGES, SO THE ABOVE LIMITATION OR EXCLUSION MAY NOT APPLY TO YOU. THIS WARRANTY IS IN LIEU OF ALL OTHER EXPRESS OR IMPLIED WARRANTIES. ALL IMPLIED WARRANTIES, INCLUDING THE WARRANTY OF MERCHANTABILITY AND THE WARRANTY OF FITNESS FOR A PARTICULAR PURPOSE, ARE HEREBY MODIFIED TO EXIST ONLY AS CONTAINED IN THIS LIMITED WARRANTY, AND SHALL BE OF THE SAME DURATION AS THE WARRANTY PERIOD STATED ABOVE. SOME STATES DO NOT ALLOW LIMITATIONS ON THE DURATION OF AN IMPLIED WARRANTY, SO THE ABOVE LIMITATION MAY NOT APPLY TO YOU.

This warranty service is available by either (a) returning the product to the dealer from whom the unit was purchased, or (b) mailing the product, along with proof of purchase, postage prepaid to the authorized service center listed below. This warranty is made by: Intermatic Incorporated/After Sales Service/7777 Winn Rd., Spring Grove, Illinois 60081-9698/815-675-7000 <http://www.intermatic.com> Please be sure to wrap the product securely to avoid shipping damage.